

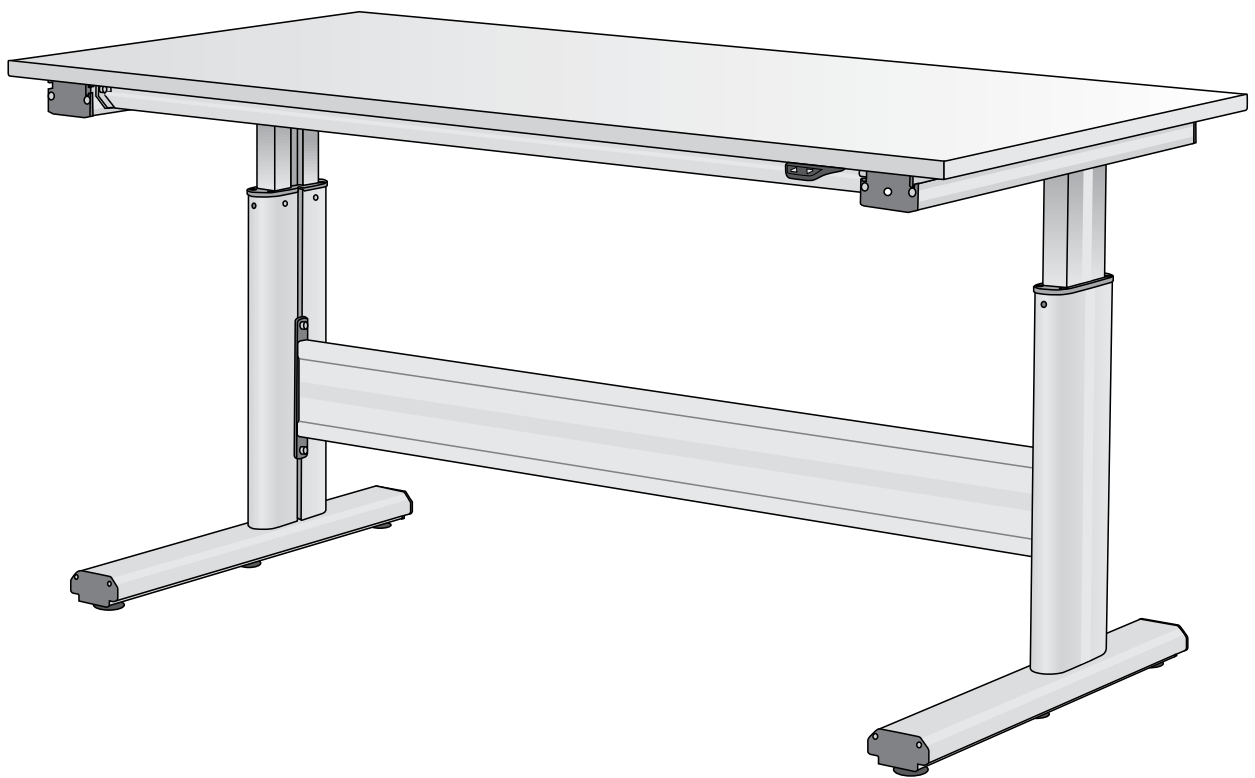

Flex 100

Worktable – Operating instructions

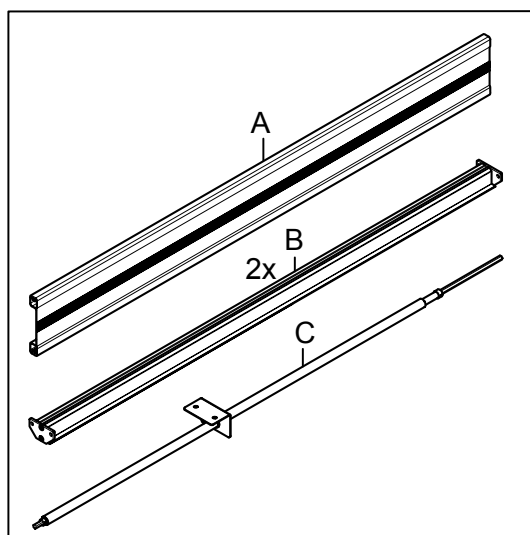

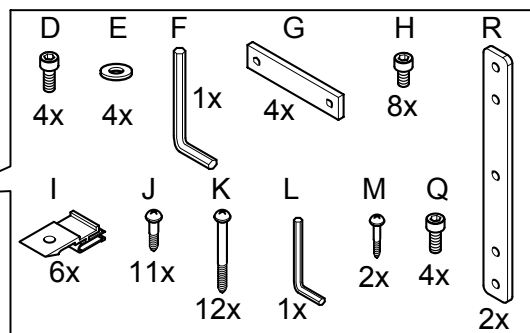
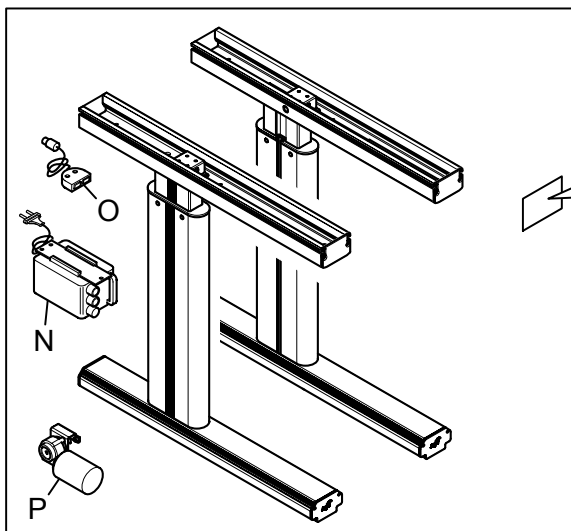

1

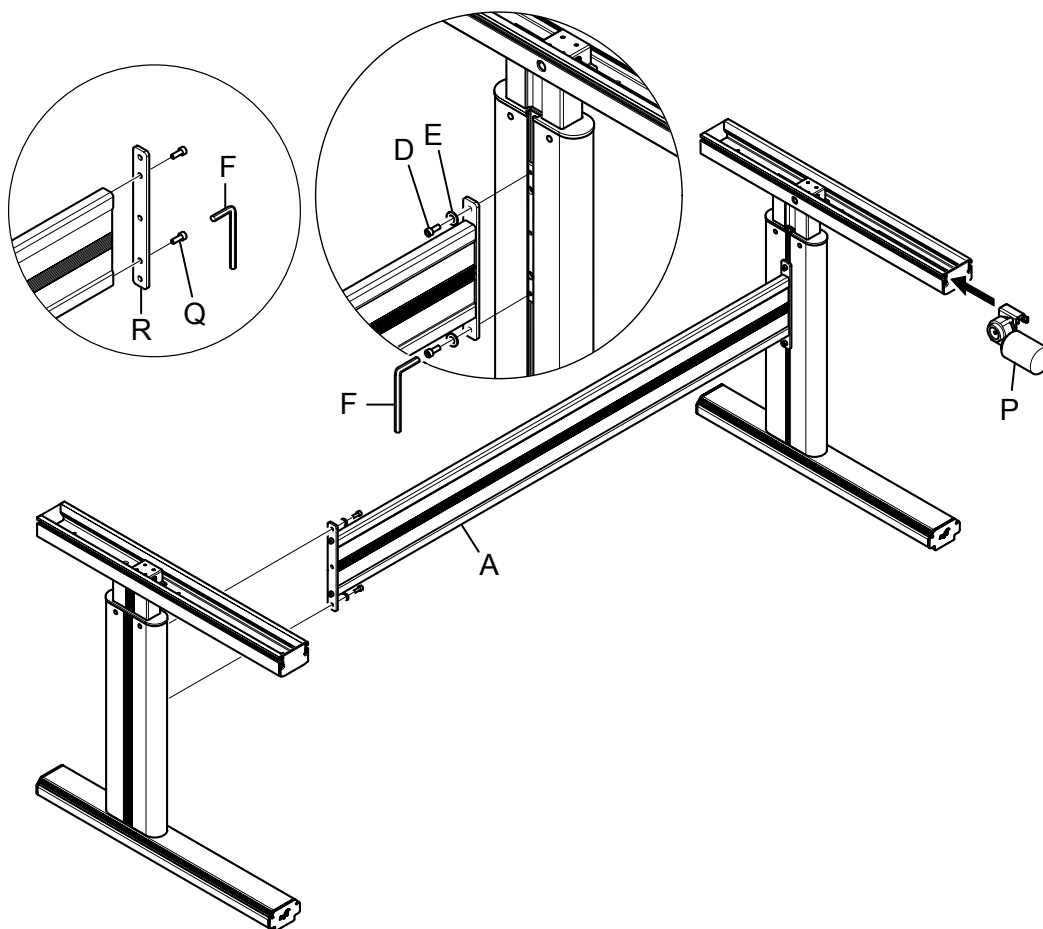

2

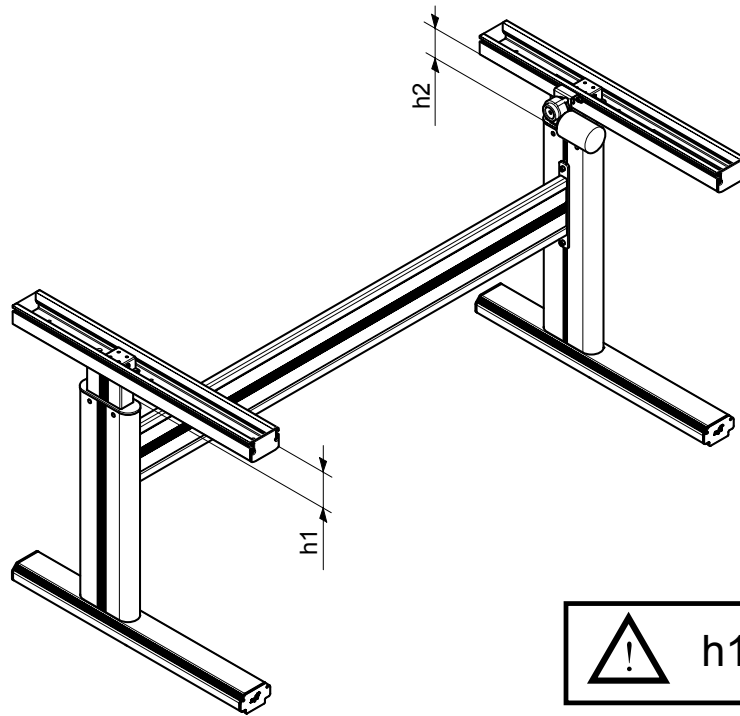

3

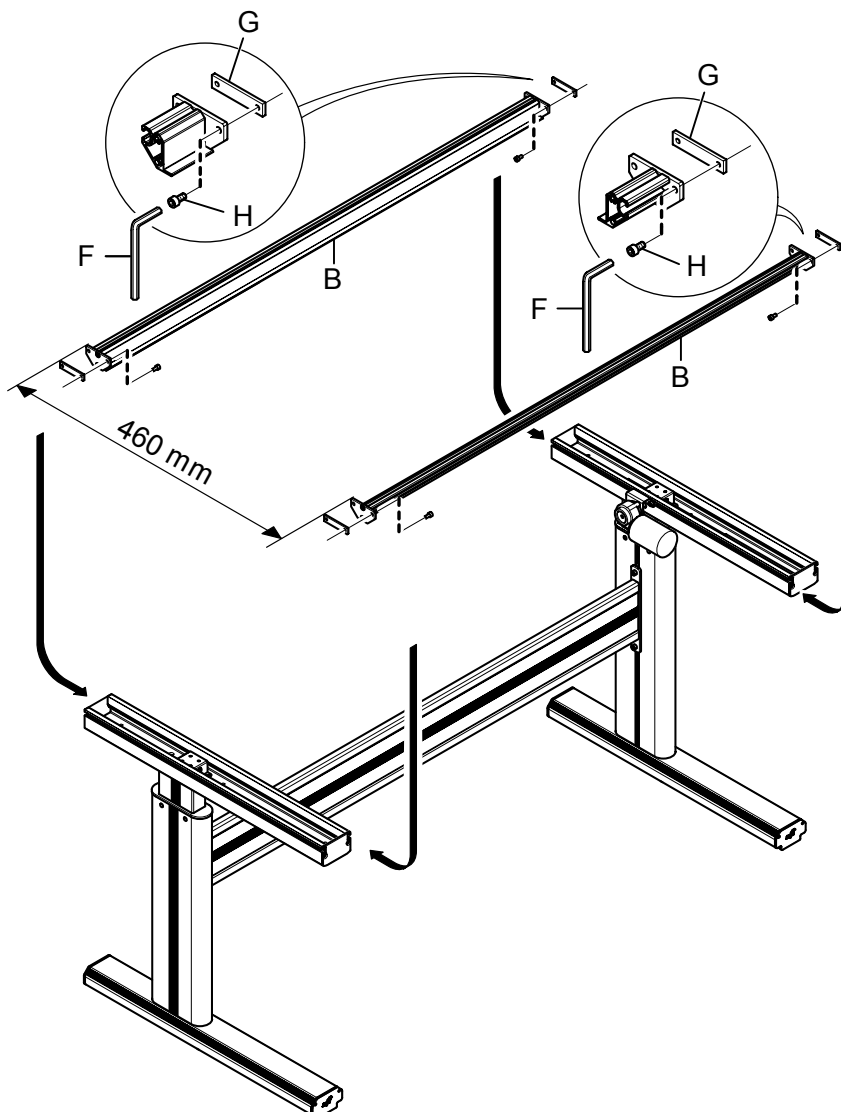

4

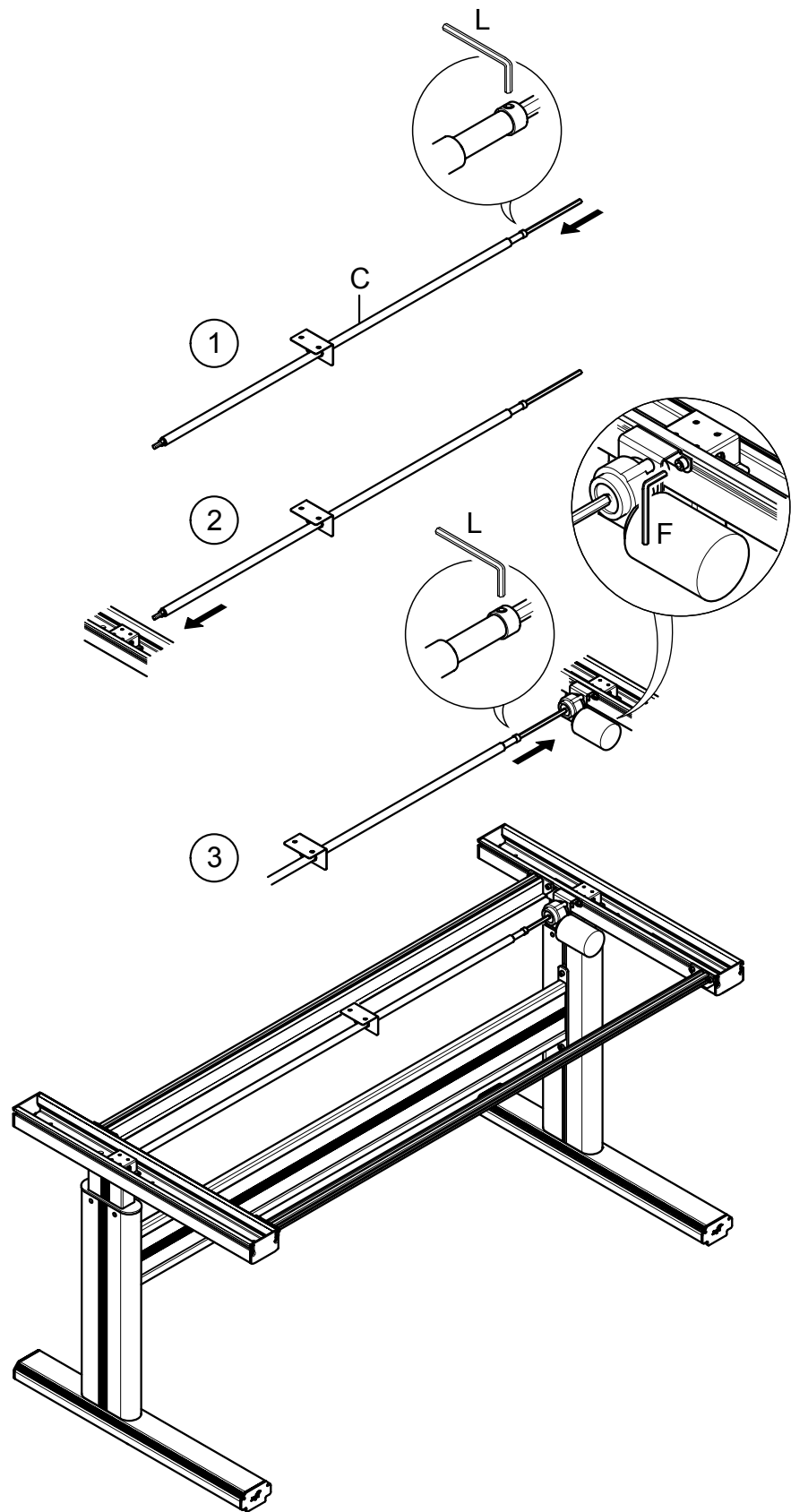

5

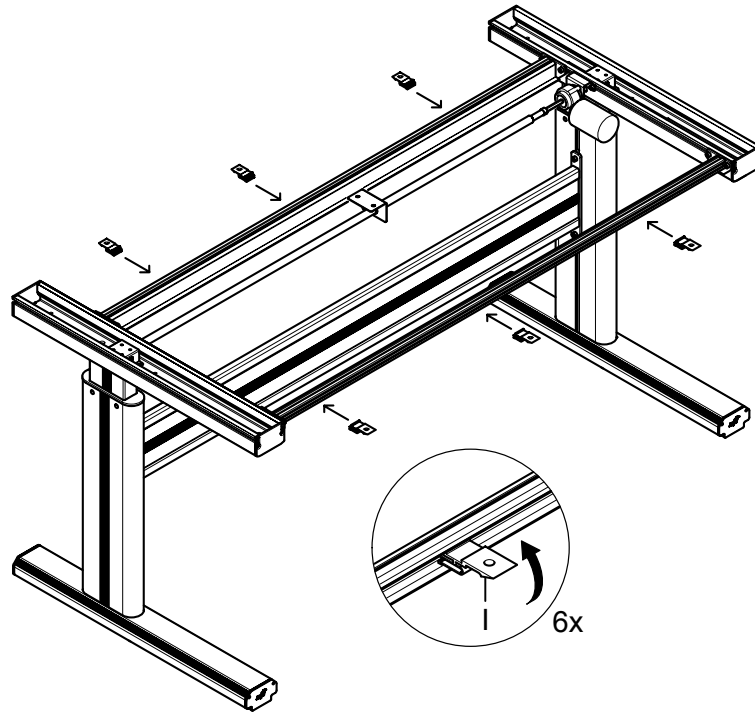

6

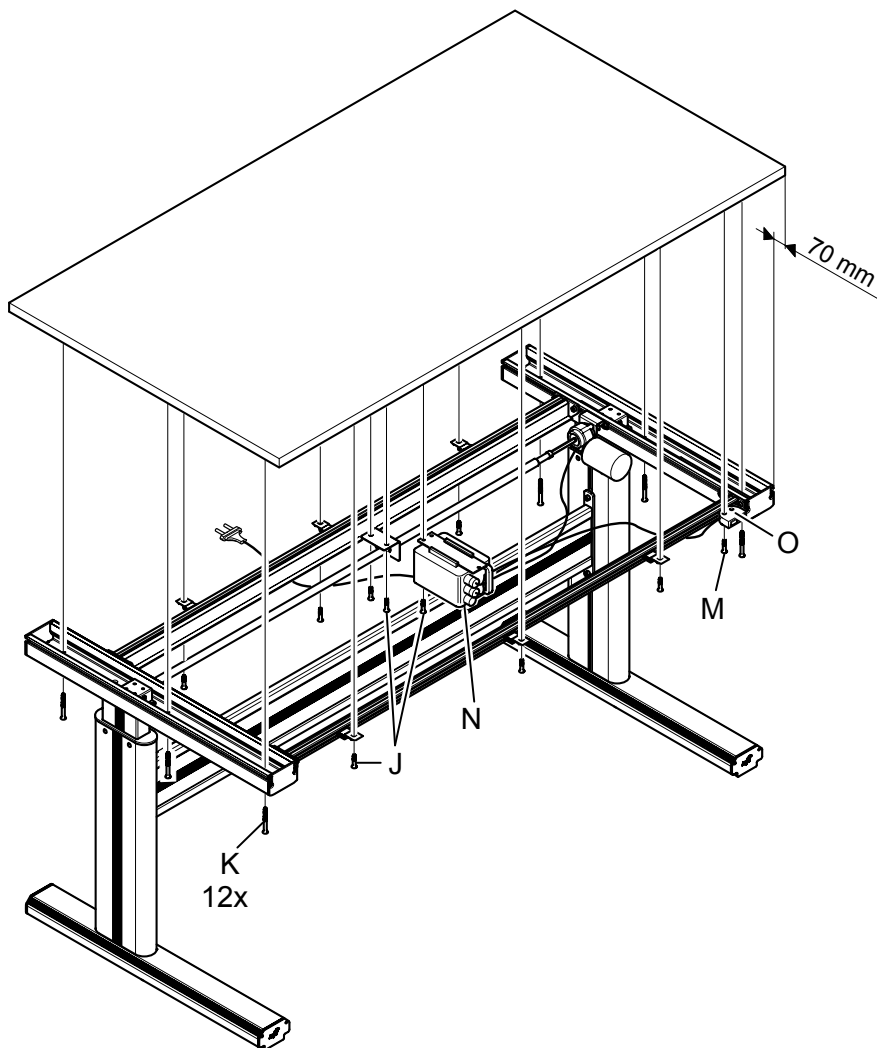

Installation instructions

- Place the table at least 120 mm from other objects, e.g. adjoining tables or equipment, or wall-mounted shelving, etc. due to the risk of crushing
 - Use the adjustable feet on the frame to make the table top level.
 - Check that electrical cables are undamaged and plug the table into a 220 – 240V, 50 Hz socket.
 - Activate/reset the table by pressing the up- and down button at the same time and hold them for about 5 seconds until there is a sound from the control box. Next push the table down to its bottom position and hold the down button until there are 3 signals from the control box. NB! During this operation the table runs at a reduced speed.
 - Do a test run to check that the drive axle runs on both sides.
- If the table is to be placed in series, additional safety devices must be installed in accordance with Gigant's instructions.
- When moving the table, never lift it by the table top because the frame is too heavy.

Description

The table is intended for indoor use in an industrial or office environment and for 10% intermittent use, max 2 min per 18 min.

Design

The image shows the table's various components. The frame must be supplemented with a suitable table top from Gigant's product range.

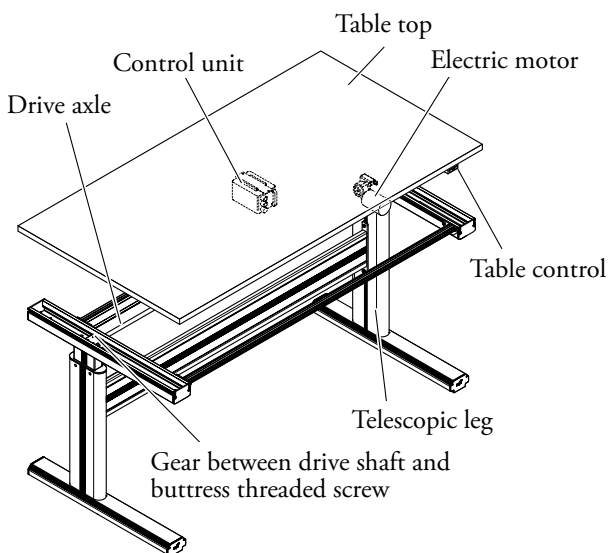

Function

The table's lift function is achieved by means of an electric single motor. The drive shaft is connected via gears to a buttress threaded screw in each of the telescopic legs.

In each telescopic leg there are glide plates that ensure a smooth and even lifting movement.

The sound pressure level at the table is lower than 70 dB(A).

Accessories

For work table Flex 100 the following accessories are available, all approved by Gigant:

- Set of wheels.
- Drawer and drawer suspension.
- Extension frame for extensions.
- Tilttable table top.
- Undershef.

Operating instructions

Raising and lowering the table

- Ensure that the table top, and anything placed on the table, has clearance in relation to surrounding objects.
- Press the table control for the desired function. The motor only runs when the button is held down.

NB! If an error occurs that stops the table moving, or stops it moving in parallel, changes stroke length or top/bottom end position, it must be reset. See installation instructions.

WARNING!

When raising or lowering the table, there is a risk of crushing between the table top or the frame and adjacent equipment. If anything placed on the table protrudes beyond the extent of the frame, the risk of tipping must be considered.

For tables with a top that can be angled:

WARNING!

If the table is equipped with a top that can be angled, the risk of crushing must be considered.

The table top must not be angled when there are loose objects on it, as this could cause personal injury.

Maintenance

All moving parts are lubricated at the factory and thus do not require maintenance.

If any servicing is required, the power must be cut off by unplugging the device.



www.gigant.co.uk