



MESH PANELS FOR APARTMENT,  
BASEMENT AND ATTIC STORAGE



# STORAGE AND PROPERTY PROTECTION



SKILL, QUALITY AND EXPERIENCE

[www.troax.com](http://www.troax.com)

# It's one thing to be a world leader

It's quite another to develop products that really are world leaders

TROAX lightweight yet secure mesh panels have an important job to do: to make an area safe. Our systems are well-planned and carefully developed to cope with great stresses. Feedback from our customers and our skilled employees makes it possible to offer the strongest and most intelligent systems in our sector.



## Three strong market segments

Troax delivers a broad range of high-quality safety solutions all over the world.

TROAX systems are marketed in three market segments: automation and robotics, material handling and logistics, and storage and property protection. By dividing operations up in this way, we can focus completely on the requirements and technical aspects within each market segment.



### Automation and robotics

Today's modern industry with advanced processes places significant demands on safety. In particular, there is a great need for controlled access for authorised personnel. Troax mesh panels are based on a carefully developed modular system that also includes special adaptations.



### Material handling and logistics

TROAX can meet all requirements for storage and security. We are suppliers to all types of industry - from traditional manufacturers that require large-scale flows and volumes through their factories to facilities with high-bay storage and retail storage. We can meet all your requirements and we offer complete solutions.



### Storage and property protection

Whether it's a question of new development or renovation of an existing installation, we are convinced that you will find our products easy to work with. Your unique needs and our creativity have contributed to our constant product development, giving rise to our motto: "Secure storage must be simple".



## Table of contents

Global presence	4-5, 20	Troax Medium	14-15
Our unique system solutions	6-7	Troax Safe	16-17
The broader perspective	8-9	Accessories	18
Overview in 2D and 3D	10	Certification	18
Our strength is in the details	11	Client login	19
Troax Classic	12-13	Service and support	19



## Sustainable product development

TROAX's own research and development department has been entrusted with continuous optimisation of our products and system solutions.

You should always feel confident with us and our products. This is therefore one of the most important parts of our business and our continued ability to translate ideas into strong products of high quality. All for your safety.

TROAX has an environment-friendly, flexible and streamlined production process. We are certified according to quality management system ISO 9001 and environmental management system ISO 14001, and we work continuously on improvements to our quality and environmental performance.





## Global presence

TROAX is represented in 27 countries, 17 of which have sales companies, and is continually expanding its business on every continent. A global presence that aims to strengthen our position worldwide.



Production facilities, Hillerstorp, Sweden

Sales Office ●  
Distribution center ●

## Local presence

We meet your needs through local sales offices backed up by daily deliveries from the world's largest warehouse for mesh panels, Troax in Hillerstorp, Sweden.



**Int. Head Office:** Troax AB P.O. Box 89 SE-330 33 Hillerstorp Sweden  
Phone +46 (0)370 828 00 Fax +46 (0)370 824 86 info@troax.com www.troax.com



# Build to suit your requirements with our unique system solutions

It is no coincidence that our systems can be adapted and constructed to suit your specific needs. Everything is intricately planned down to the smallest detail. The security levels of our three systems can also be combined with each other which is an innovative way in which to give you the most affordable and future-proof solution.

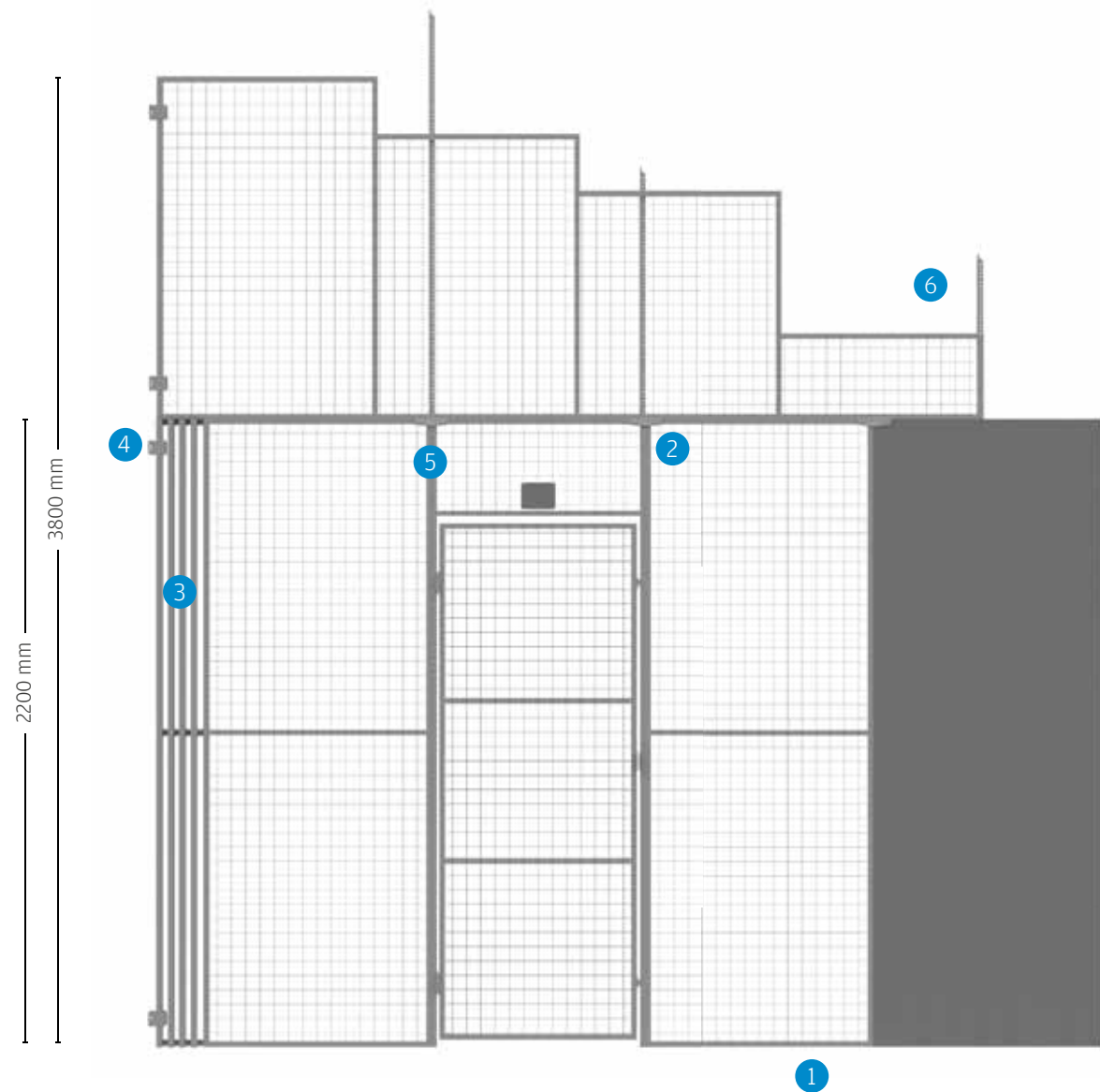

## PANEL SYSTEMS

Door (HxW) mm:	Door type
2200x750	Classic, Medium
2200x900	Classic, Medium, Safe, UR SP

Panel (HxW) mm:	Panel type
2200x200	Classic, Medium, Safe, UR SP
2200x300	Classic, Medium, Safe, UR SP
2200x500	Classic, Medium
2200x700	Classic, Medium, Safe, UR SP
2200x800	Classic, Medium, Safe, UR SP
2200x1000	Classic, Medium, Safe, UR SP
2200x1200	Classic, Medium, Safe, UR SP
2200x1500	Classic, Medium, Safe



**1 Floor support**  
The simple and unique floor support allows adjustments to be made in case of an uneven floor, for instance.

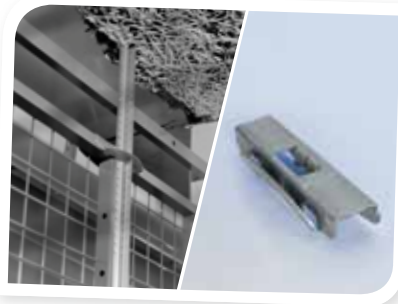

**2 Snapper**  
Our snappers are used to fix panels together safely and strongly; this also makes the ceiling mounting incredibly strong.



**3 Filler kit**  
Used to easily fill gaps in the wall system using the filler pipe which is secured into the smart profile.



**4 Wall fixing**  
With our wall fixings, panels can be adjusted and secured to adjoining structures in the best possible way.



**5 Screws and fittings**  
Our system is based on our self-tapping screws in combination with a variety of different fittings to provide incredibly strong and flexible fixings.



**6 U-profile**  
Used to conceal sharp edges when adaptations have been made.



# The broader perspective

Whether for a new construction or renovation, Troax provides customers with the high levels of safety and security they expect. With several security levels and a variety of different lock and door designs, you get a storage system suited to most properties.

Our mesh panels are effective against break-ins and vandalism. Additionally, they provide a fresh environment with good ventilation. It is, quite simply, a good investment for secure and satisfied tenants.



**Garage** The system is based on modular mesh panels and secures garages against break-ins and vandalism. Regardless of the security level you choose - a standard or customised design - you will get a secure and flexible garage system.



**Steel panels** UR SP is a secure, durable, and easy-to-assemble storage solution - ideal for when you need a system which protects your privacy. UR SP can be easily combined with our other types of mesh storage panels.



**Loft space** Our flexible systems are easily adapted to the situation at hand, such as sloping ceilings in loft spaces.



**Troax Safe** Our absolute safest product. Certified according to the Swedish Theft Prevention Association's standard for storage installations which protect against break-ins and suited to spaces which are particularly vulnerable to being broken into.

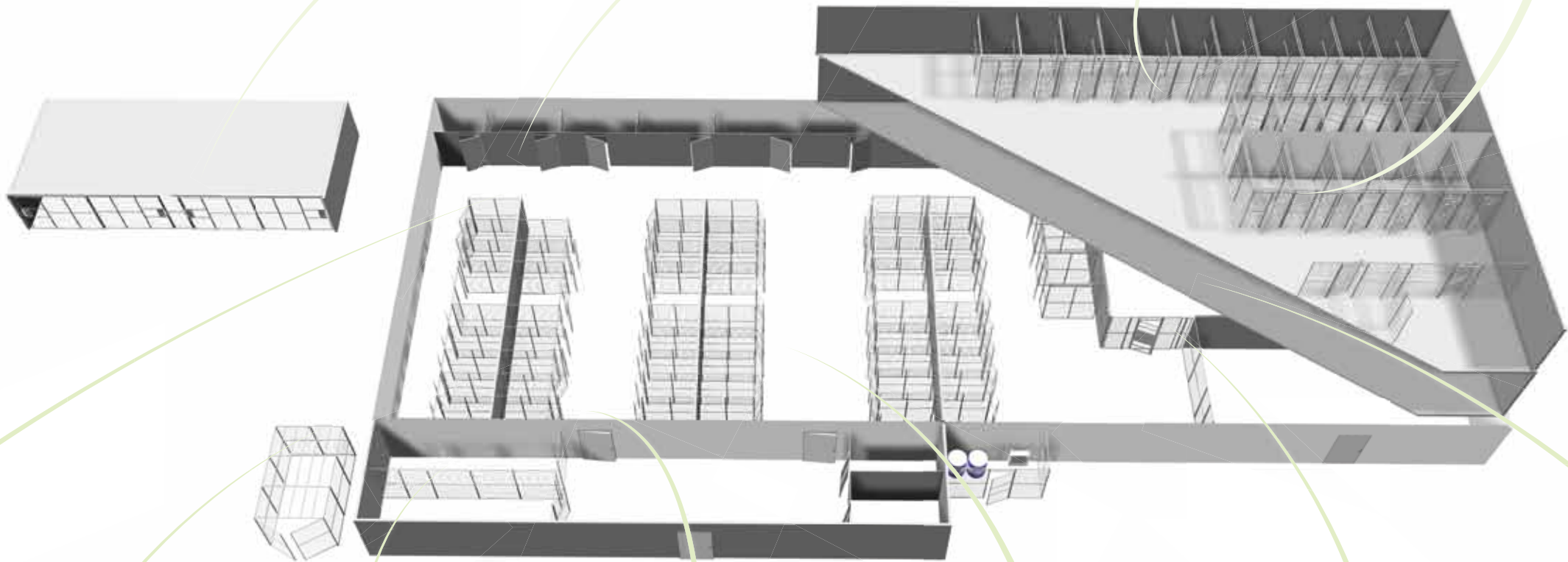

**Rental storage** Our storage solutions can be built using mesh panels, or steel panels which offer privacy protection. If the structure does not reach the height of the ceiling, mesh panels are recommended for extra protection.



**Troax box** Our boxes can be used both indoors and out, and as a permanent or temporary solution.



**Troax Classic** An excellent choice of mesh panel for areas which have good external protection and little risk of damage. It can also be used as a partition wall with our other systems to achieve an optimal solution.



**Troax Medium** Used primarily in areas where you need good protection against uninvited guests. In combination with approved locks, the risk of break-in attempts is reduced.



**Doors** Our secure, threshold-less door systems in the Classic and Medium ranges make passage easier.



**Enclosure** Our Caelum wall system is flexible and can be easily adapted to locations which are difficult to access.



**Server rooms** Our modular systems, with or without mesh ceilings, can be fit at any height. The mesh panels allow complete airflow circulation and can be adjusted to fit around existing installations and other obstacles.



# Drawings and overview in 2D and 3D

We have extensive experience in protecting people and materials in dangerous environments. Our sales staff can easily guide you through the different stages so that the solution we offer meets your needs.

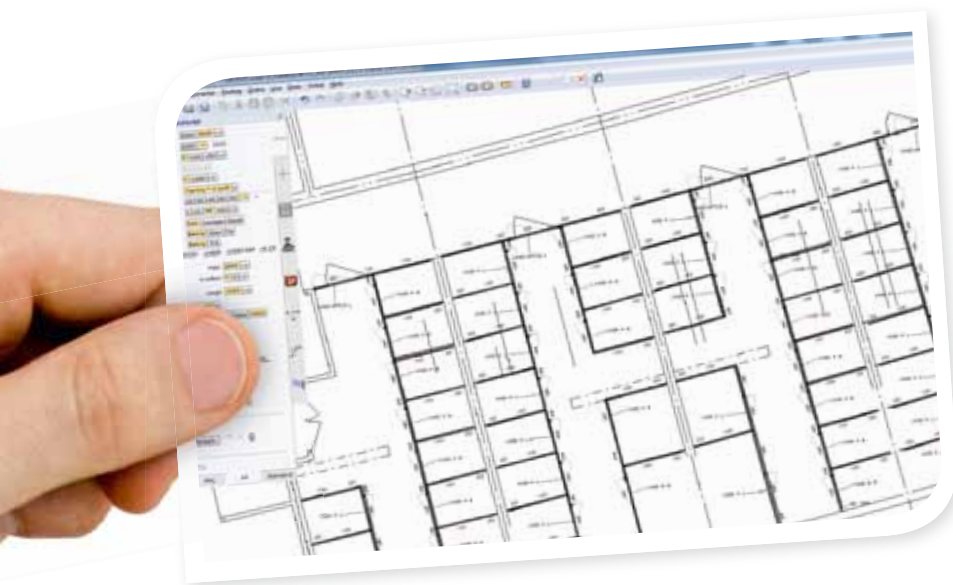

Imagining how a solution may look before the material has been ordered can be difficult.

We can solve that problem using our Configura drawing and 3D rendering tool. Even before you order material from us, you can view our proposal via 2D and 3D generated drawings. This makes it easier to make a decision with no unpleasant surprises to come.

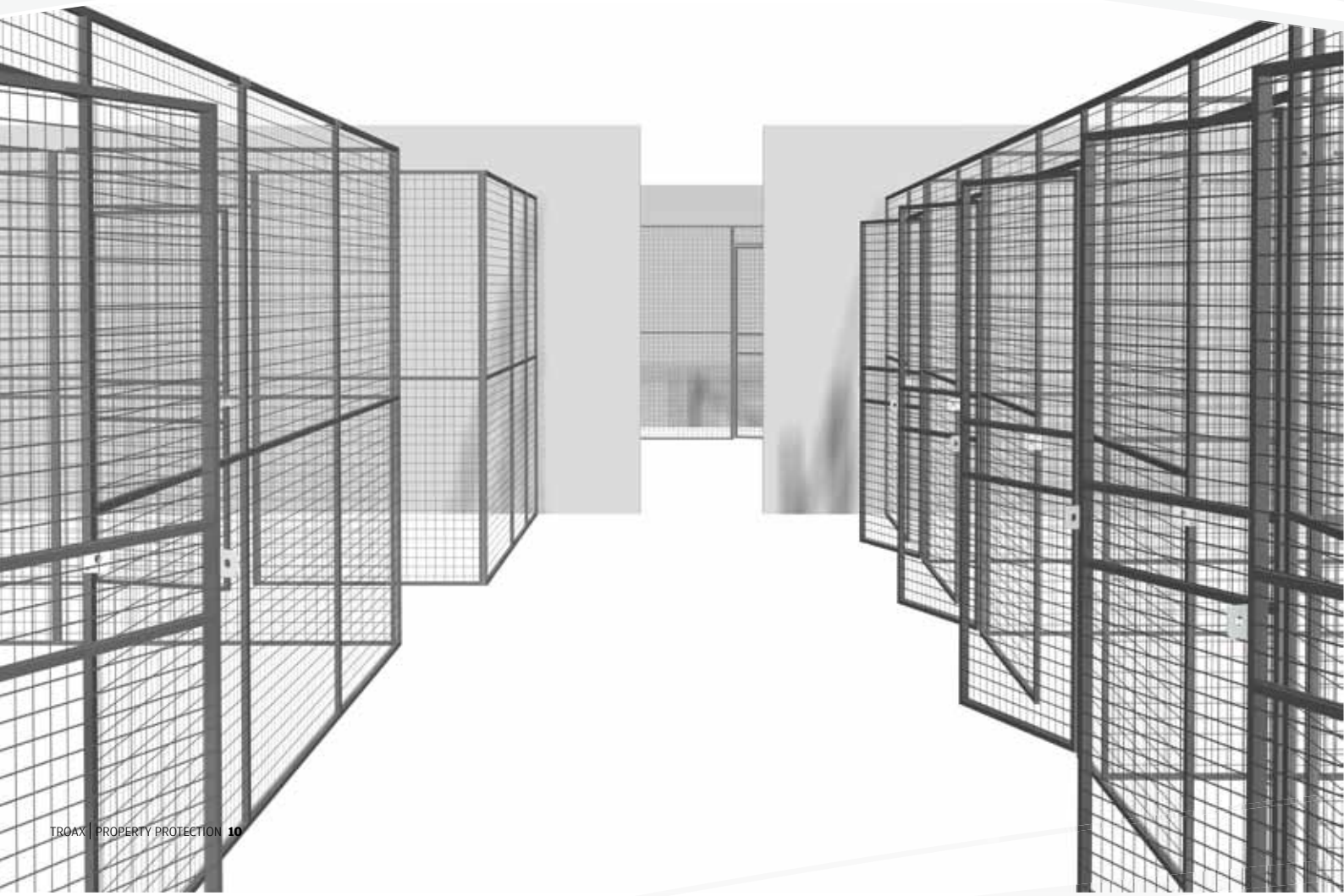

# Our strength is in the details

In order to produce a strong panel and to develop more efficient manufacturing, as well as simultaneously meeting performance requirements, we have opted to make the frames with a profile in the horizontal tubes. Everything is manufactured in a highly-automated facility for the absolute highest quality.

## TROAX CLASSIC

FOR LOW-RISK PROPERTY PROTECTION

### TROAX CLASSIC

The Troax Classic Panel is an entry-level variant based on a welded tube construction of 19x19mm. The mesh consists of pressure welded wire gauges, each 2.5mm, with the mesh equivalent to 50x50mm.

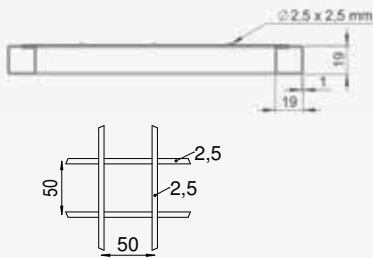

## TROAX MEDIUM

FOR MEDIUM-RISK PROPERTY PROTECTION

### TROAX MEDIUM

The Troax Medium Panel is a stronger variant based on a welded tube construction of 30x20mm. The mesh consists of pressure welded wire gauges of 3x3.75mm, with the mesh equivalent to 50x50mm.

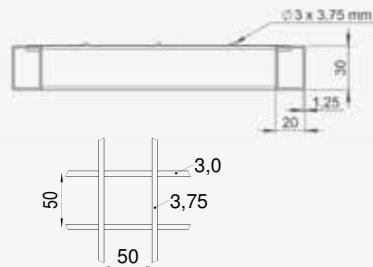

## TROAX SAFE

FOR HIGH-RISK PROPERTY PROTECTION

### TROAX SAFE

The Troax Safe Panel is our strongest variant based on a welded tube construction of 30x20mm. The mesh consists of pressure welded wire gauges, each 5mm, with the mesh equivalent to 50x50mm.

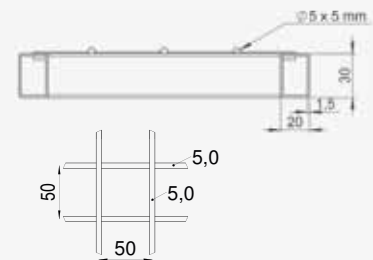



# TROAX CLASSIC

FOR LOW-RISK PROPERTY PROTECTION

This is an excellent choice of mesh panel for areas which have good external protection and little risk of damage. It can also be used as a partition wall with our other systems to achieve an optimal solution. The mesh panels allow light and air to pass

freely, and the ability to “see around the corner” gives a sense of security. It also provides the ability to quickly detect and extinguish any fires directly through the mesh panel. The threshold-less door system is based on the same leaf as Troax Medium.

## Technical information

### Panels (HxW) mm:

Panel Classic	2200 x 200
Panel Classic	2200 x 300
Panel Classic	2200 x 500
Panel Classic	2200 x 700
Panel Classic	2200 x 800
Panel Classic	2200 x 1000
Panel Classic	2200 x 1200
Panel Classic	2200 x 1500

### Door with padlock fittings (H:2200mm)

Door Classic P 750 H (opening H: 1860mm)
Door Classic P 750 V (opening H: 1860mm)
Door Classic P 900 H (opening H: 2000mm)
Door Classic P 900 V (opening H: 2000mm)

### Component information

Frame:	19 x 19 x 1,0 mm
Wire:	2,5 x 2,5 mm
Mesh:	50 x 50 mm
Surface treatment:	Powder coating, Grey RAL 7037

Also available in a galvanised finish and RAL colours.

**Strike plate**  
The Classic door is supplied for use with padlocks



**Panel Classic**  
Forms the basis of the Classic system



## Doors and panels

All doors have a height of 2200 mm

Padlocks



Panels

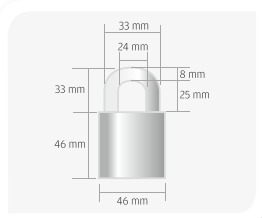
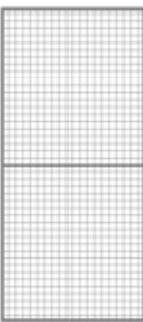

Recommended padlocks



Threshold-less door systems.



Welded numbered plates as standard.



Flexible chipboard shelf with brackets.



Choose UR 350 when you need a mesh panel for areas where there is little risk of being broken into. This mesh panel can also be used as a partition wall together with our other systems.





# TROAX MEDIUM

FOR MEDIUM-RISK PROPERTY PROTECTION

Used primarily in areas where you need good protection against uninvited guests. In combination with approved locks, the risk of break-in attempts is reduced. Using Troax accessories and innovative installation methods, the structure can be tailored to almost any location, be it large or

small, with a low or high ceiling, or even sloping floors. The mesh panels allow light and air to pass freely, and the ability to “see around the corner” gives a sense of security. It also provides the ability to quickly detect and extinguish any fires directly through the mesh panel.



**Panel**  
Forms the basis of the Medium system



**UR SP**  
For a fully-covered solution to protect your privacy



**Flexible chipboard shelf**  
With brackets

## Doors and panels

All doors have a height of 2200 mm

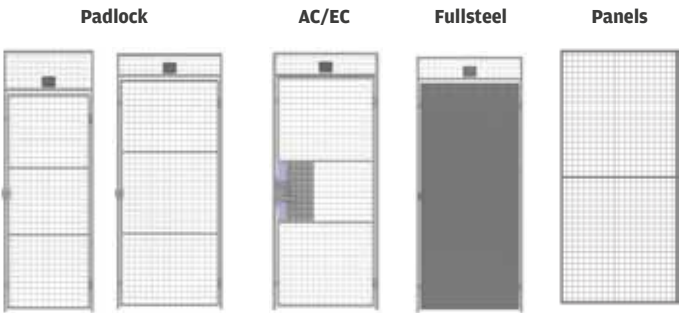

## Locks



**Padlock with cover**  
The Medium door is supplied with a strong strike plate protected by welded casing.



**ASSA Cylinder lock**  
Strong lock casing for ASSA cylinder.



**Securing plate for padlocks**  
UR SP metal door with a padlock plate.



**EURO Cylinder lock**  
Strong lock casing for ASSA cylinder.

### Technical information

#### Panels (HxW) mm:

Panel Medium	2200 x 200
Panel Medium	2200 x 300
Panel Medium	2200 x 500
Panel Medium	2200 x 700
Panel Medium	2200 x 800
Panel Medium	2200 x 1000
Panel Medium	2200 x 1200
Panel Medium	2200 x 1500

#### Door with padlock fittings (H:2200mm)

Door Medium P 750 H (opening H: 1860mm)  
Door Medium P 750 V (opening H: 1860mm)  
Door Medium P 900 H (opening H: 2000mm)  
Door Medium P 900 V (opening H: 2000mm)

#### Door ready for EURO cylinder (H:2200mm)

Door Medium EC 900 H (opening H: 2000mm)  
Door Medium EC 900 V (opening H: 2000mm)

#### Door ready for ASSA cylinder (H:2200mm)

Door Medium AC 900 H (opening H: 2000mm)  
Door Medium AC 900 V (opening H: 2000mm)

#### Component information

Frame:	30 x 20 x 1,25 mm,
Wire:	3,0 x 3,75 mm
Mesh:	50 x 50 mm
Surface treatment:	Powder coating, Grey RAL 7037

Also available in a galvanised finish and RAL colours.





# TROAX SAFE

FOR HIGH-RISK PROPERTY PROTECTION

The customer's need for security has been the focus of the development of our most secure product. Troax Safe is part of a system with specially adapted installation fittings. The system has been tested and approved by the Swedish Theft Prevention Association (SSF) and is used in areas which are particularly susceptible to break-in attempts. Examples of such areas include

apartment storerooms, cycle storerooms, buggy storerooms, sectioning, etc. The mesh panels allow light and air to pass freely, and the ability to "see around the corner" gives a sense of security. It also provides the ability to quickly detect and extinguish any fires directly through the mesh panel.

## Doors and panels

All doors have a height of 2200 mm

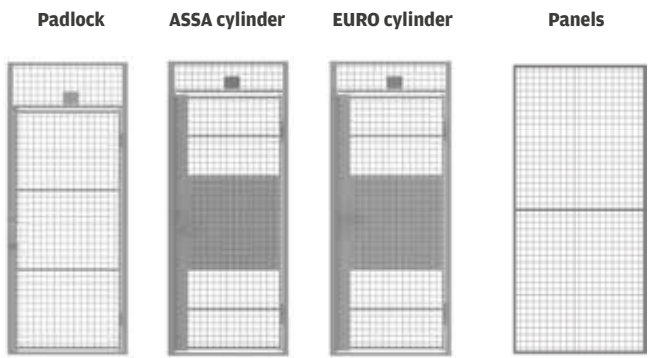

**Cylinder locks**  
Available both with ASSA and Euro cylinders



**Profile system**  
To secure the installation, there are several strong profile options.



**Securing on the rear edge**  
Secures the door leaf if the hinge is tampered with, such as in instances of a break-in attempt.



**Secure installation**  
Using the profile system, all joints are secured in case of a break-in attempt.

### Technical information

#### Panels (HxW) mm:

Panel Troax Safe	2200 x 200
Panel Troax Safe	2200 x 300
Panel Troax Safe	2200 x 700
Panel Troax Safe	2200 x 800
Panel Troax Safe	2200 x 1000
Panel Troax Safe	2200 x 1200
Panel Troax Safe	2200 x 1500

#### Door with padlock fittings (H:2200mm)

Door Troax Safe	P 750 H (opening H: 1860mm)
Door Troax Safe	P 750 V (opening H: 1860mm)

#### Door ready for Euro cylinder (H:2200mm)

Door Troax Safe	EC 900 H (opening H: 1970 mm)
Door Troax Safe	EC 900 V (opening H: 1970 mm)

#### Door ready for ASSA cylinder (H:2200mm)

Door Troax Safe	AC 900 H (opening H: 2000mm)
Door Troax Safe	AC 900 V (opening H: 2000mm)

#### Component information

Frame:	30 x 20 x 1.5 mm
Wire:	5,0 x 5,0 mm
Mesh:	50 x 50 mm
Surface treatment:	Powder coating, Grey RAL 7037

Also available in a galvanised finish and RAL colours.



**Troax Safe**  
The system has been tested and approved by the Swedish Theft Prevention Association (SSF).



**Padlock with cover**  
Safe doors are supplied with a strong strike plate protected by welded casing.



**Panel**  
Forms the basis of the Safe system.







## 1 END profile

The END profile is a flexible solution for adjusting the width of the mesh panel while still retaining strength and stability.

## 2 U-Profile

The U-profile is a flexible accessory following adaptation and to conceal sharp edges. Available galvanised or varnished.

*END and U-profiles are accessories which are fully compatible with all TROAX mesh panels and systems.*

# myTROAX

myTROAX is an online resource with tools for your day-to-day dealings with Troax and our products.



MYTROAX NOW  
IS YOUR TROAX.  
**SIGN UP TODAY!**

➔ [troax.com/mytroax](http://troax.com/mytroax)

## Certification

### Troax - a safe choice

Years of experience together with a high level of technical expertise have driven the development of our certified system, Troax Safe, based on our sturdy Panel, which has been designed for the toughest of environments.

This, together with automated production, guarantees unbeatably high quality, and more importantly, consistent quality. In sum, this has resulted in a system which has been tested and approved by the Swedish Theft Prevention Association (SSF).



## Service och support

Our technicians have a wealth of experience both in installation and service. In order to offer quick delivery, we keep products in stock for the sake of your security.

We can assemble your storage quickly and efficiently so that you can forget about wondering whether the storage has been installed properly.



### Grey increases visibility

TROAX can supply mesh panels and systems in any colour. But the grey colour of our mesh panels and systems is not just coincidental. This colour has a very important function: visibility. Additionally, dust and dirt cannot be seen as clearly thanks to the grey colour.





- |  |   |   |
|--|---|---|
|  <b>Troax GmbH, Austria</b><br>Tel: +43 2254 76 371<br>E-mail: <a href="mailto:info@troax.at">info@troax.at</a>   |  <b>Troax GmbH, Germany</b><br>Tel: +49 6127 9079 0<br>E-mail: <a href="mailto:info@troax.de">info@troax.de</a>  |  <b>Troax Systems, S.L. Spain</b><br>Tel: +34 93 568 40 00<br>E-mail: <a href="mailto:info@troax.es">info@troax.es</a><br><br><b>Troax Systems Madrid</b><br>Tel: +34 91 103 25 79<br>E-mail: <a href="mailto:madrid@troax.es">madrid@troax.es</a> |
|  <b>Troax, Belgium</b><br>Tel: +32 15 28 17 30<br>E-mail: <a href="mailto:info@troax.be">info@troax.be</a>  |  <b>Troax Italy S.R.L.</b><br>Tel: 800 787 005<br>E-mail: <a href="mailto:info@troax.it">info@troax.it</a>   |   |
|  <b>VECSA International - Consultoria e Sistemas de Seguranca Ltda. Brazil</b><br>Tel: +55 11 3528 4567<br>E-mail: <a href="mailto:vendas@troax.com.br">vendas@troax.com.br</a> |  <b>MORITA &amp; COMPANY, Japan</b><br>Tel: +81 568 77 1241<br>E-mail: <a href="mailto:service@morita-c.co.jp">service@morita-c.co.jp</a>  |  <b>Troax AB (Head Office), Sweden</b><br>Tel: +46 370 828 00<br>E-mail: <a href="mailto:info@troax.com">info@troax.com</a><br><br><b>Troax Nordic AB</b><br>Tel: +46 370 828 00<br>E-mail: <a href="mailto:info@troax.se">info@troax.se</a>       |
|  <b>Gunnebo Troax China Sales</b><br>Tel: +86 21 546 629 78<br>E-mail: <a href="mailto:info.china@troax.cn">info.china@troax.cn</a>   |  <b>Troax BV, Netherlands</b><br>Tel: +31 252 370 154<br>E-mail: <a href="mailto:info@troax.nl">info@troax.nl</a>  |   |
|  <b>Troaks d.o.o. Croatia</b><br>Tel: +385 47 64 20 71<br>E-mail: <a href="mailto:info.croatia@troax.com">info.croatia@troax.com</a>   |  <b>Troax Nordic AB, Norway</b><br>Tel: +47 22 80 42 00<br>E-mail: <a href="mailto:info@troax.no">info@troax.no</a>   |  <b>Troax Schweiz AG, Switzerland</b><br>Tel: +41 52 740 03 36<br>E-mail: <a href="mailto:info@troax.ch">info@troax.ch</a>   |
|  <b>Troax CZ s.r.o. Czech Republic</b><br>Tel: +420 312 246 820<br>Tel: +420 312 246 821<br>E-mail: <a href="mailto:info@troax.cz">info@troax.cz</a>                          |  <b>Troax Polska Sp. z o.o.</b><br>Tel: +48 (61) 663 27 02<br>E-mail: <a href="mailto:info@troax.pl">info@troax.pl</a>   |  <b>Troax Endüstri İnşaat, Turkey</b><br>Tel: +90 212 607 24 94<br>E-mail: <a href="mailto:murat.daskin@troax.com">murat.daskin@troax.com</a>  |
|  <b>Troax Denmark A/S</b><br>Tel: +45 43 71 02 33<br>E-mail: <a href="mailto:info@troax.dk">info@troax.dk</a>   |  <b>Troax Russia</b><br>Tel/Fax: +7 (925) 771 28 51<br>E-mail: <a href="mailto:egor.belofast@troax.com">egor.belofast@troax.com</a>  |  <b>Troax UK Ltd, United Kingdom</b><br>Tel: +44 1793 542 000<br>E-mail: <a href="mailto:info@troax.co.uk">info@troax.co.uk</a>  |
|  <b>Troax Nordic AB, Finland</b><br>Tel: +358 10 321 4210<br>E-mail: <a href="mailto:info@troax.fi">info@troax.fi</a>   |  <b>TROAX SK s.r.o. Slovakia</b><br>Tel: +421 903 655 625  |  <b>Lee Manufacturing Ltd</b><br>Tel: +44 1384 277 441<br>E-mail: <a href="mailto:info@troaxlee.co.uk">info@troaxlee.co.uk</a>   |
|  <b>Troax SAS, France</b><br>Tel: +33 479 96 66 30<br>E-mail: <a href="mailto:info@troax.fr">info@troax.fr</a>  |  <b>E-mail: <a href="mailto:pavol.kapral@troaxsk.sk">pavol.kapral@troaxsk.sk</a></b><br><b>Votem Autotech Co., Ltd. South Korea</b><br>Tel: +82 (0)52 283 0501<br>E-mail: <a href="mailto:andrew.kim@mdtkorea.net">andrew.kim@mdtkorea.net</a> |  <b>Troax, Inc. USA</b><br>Tel: +1 (615) 730-7581<br>E-mail: <a href="mailto:info@troax.us">info@troax.us</a>  |



**Int. Head Office:** Troax AB P.O. Box 89 SE-330 33 Hillerstorp Sweden  
Phone +46 (0)370 828 00 Fax +46 (0)370 824 86 [info@troax.com](mailto:info@troax.com) [www.troax.com](http://www.troax.com)